

Welcome

Dear Friends,

Welcome to First Baptist Church! We are glad that you have chosen to worship with us. I hope this guide will help you find your destination here at our church. If you still encounter difficulties finding your location, please ask anyone and we would be happy to help.

These room numbers and locations are important but they represent so much more. They represent rooms where Scripture is studied and friendships are made. We hope that God will revolutionize your life through the Bible and wonderful Christian friendships. I trust you will find a place to develop and grow in faith in Jesus.

The Bible tells that God loves us and offers a wonderful plan for our lives. God's plan is always fulfilled in a local body of believers. The church is a place where strength can be drawn and faith can be developed. Please find an evangelical church where you can receive that strength and grow your faith. This guide may help you find your place within the building that houses First Baptist Church, but for all of us, the ultimate destination is in a relationship with God's Son, Jesus. May God bless you as you journey through this building and as you journey through life.

In His Love,



Senior Pastor

Wednesday Evening Activities

(Late August - mid-May)

| | |
|--|--|
| Adult Bible Studies6:00-7:30 PM | Nursery/Childcare6:00-7:30 PM |
| Bible Study with the Pastor Sanctuary | Infants 401A |
| All remaining studies.....Balcony | Toddlers & 2 yr olds402B |

| | |
|--|---|
| Youth6:00-7:30 PM | Kingdom Sprouts (Preschool) 5:30-7:30 PM |
| Cross LIFE (6 th -12 th Grade)..... Youth Area | 3 Yr Olds 402F |
| | 4 Yr Olds 407 |
| | 5 Yr Olds 413 |

| |
|--|
| Kreative Kids (Children) 5:30-7:30 PM |
| 1st - 5th GradeF.H. Back |

alive!
in the power of God

- aadore God
- love all people
- iinvest in God's work
- Value God's word
- eexpand God's kingdom

FIRST BAPTIST CHURCH
425 Eastern ByPass
Richmond, KY 40475
(859) 623-4028
www.fbcrichmondky.church

For more information contact:
Sam Newman, Minister of Education/Discipleship
sam.newman@firstbaptistnet.com

First Baptist Church

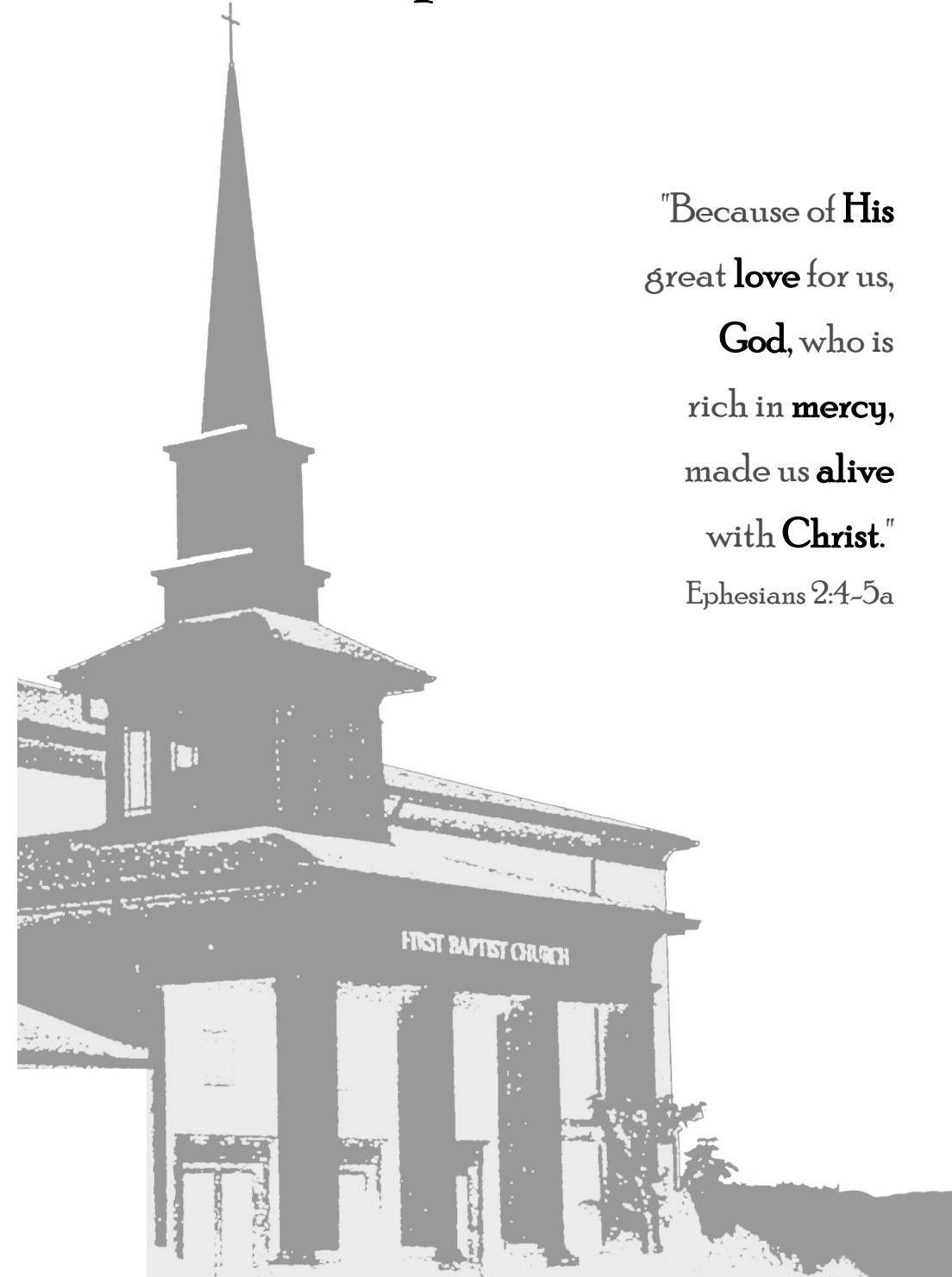

"Because of His
great love for us,
God, who is
rich in mercy,
made us alive
with Christ."
Ephesians 2:4-5a

Ministry Activity Guide

Sundays & Wednesdays

Sunday School • Worship • Discipleship

Sunday Morning

Worship9:30 & 11:00 AM
 Nursery/Childcare (Birth-2 Yrs) 8:00 AM
 Bible Study (Adults) 8:15, 9:30, 11:00 AM
 Bible Study (Youth).....9:30 AM
 Bible Study (Children)9:30 AM
 Bible Study (Preschool).....9:30 & 11:00 AM
 Hispanic Worship 12:15 PM
 (Contact Sam Newman, 859-623-4028, ext. 203

regarding Hispanic Bible Studies.)

Sunday Evening

All Activities6:00 PM
 Worship Fellowship Hall Front
 Nursery/Childcare..... Preschool Wing

Childcare

We encourage you to enroll your child into one of our outstanding children's programs during our A.M. and P.M. events and let them experience God their way. There is also a Cry Room located at the

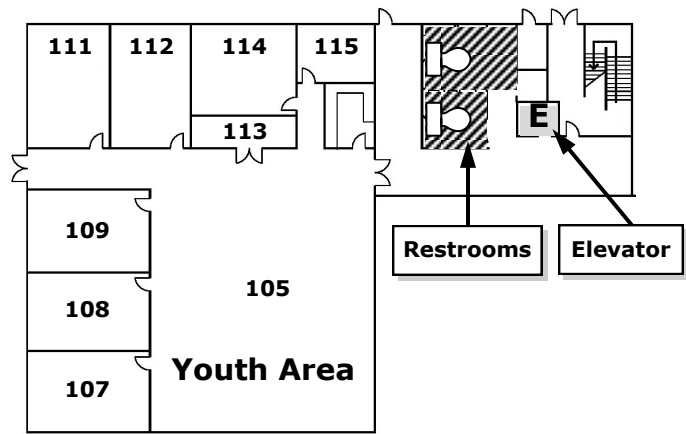

Lower Level
(Ground Floor)

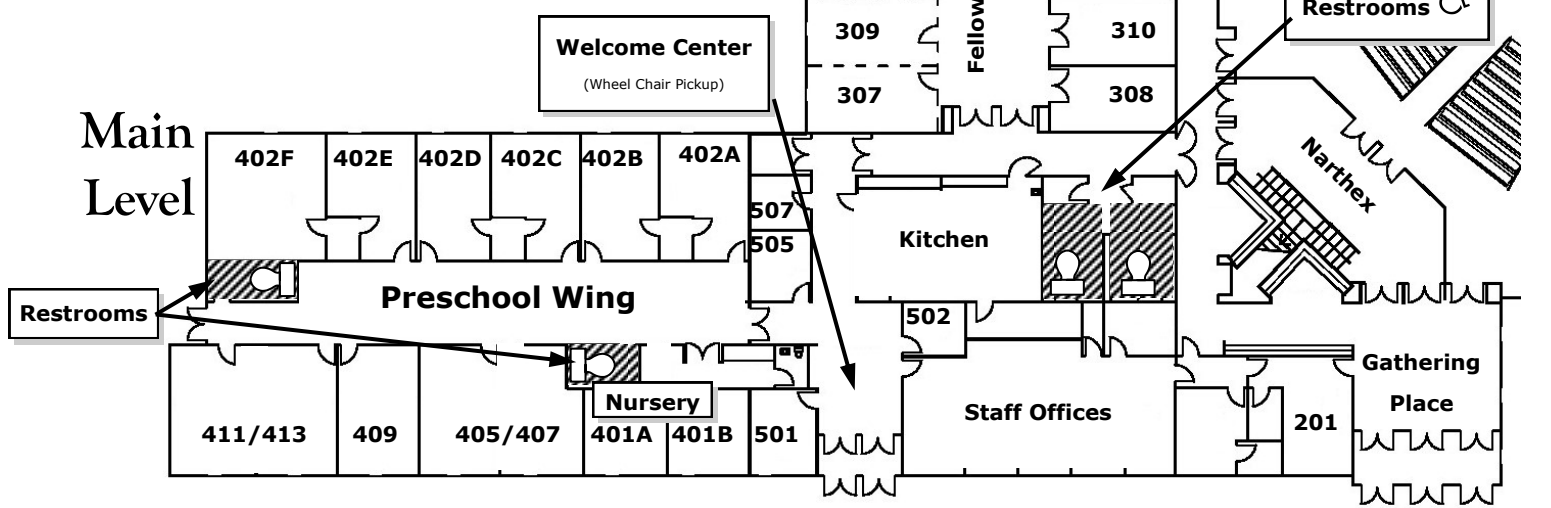

Main Level

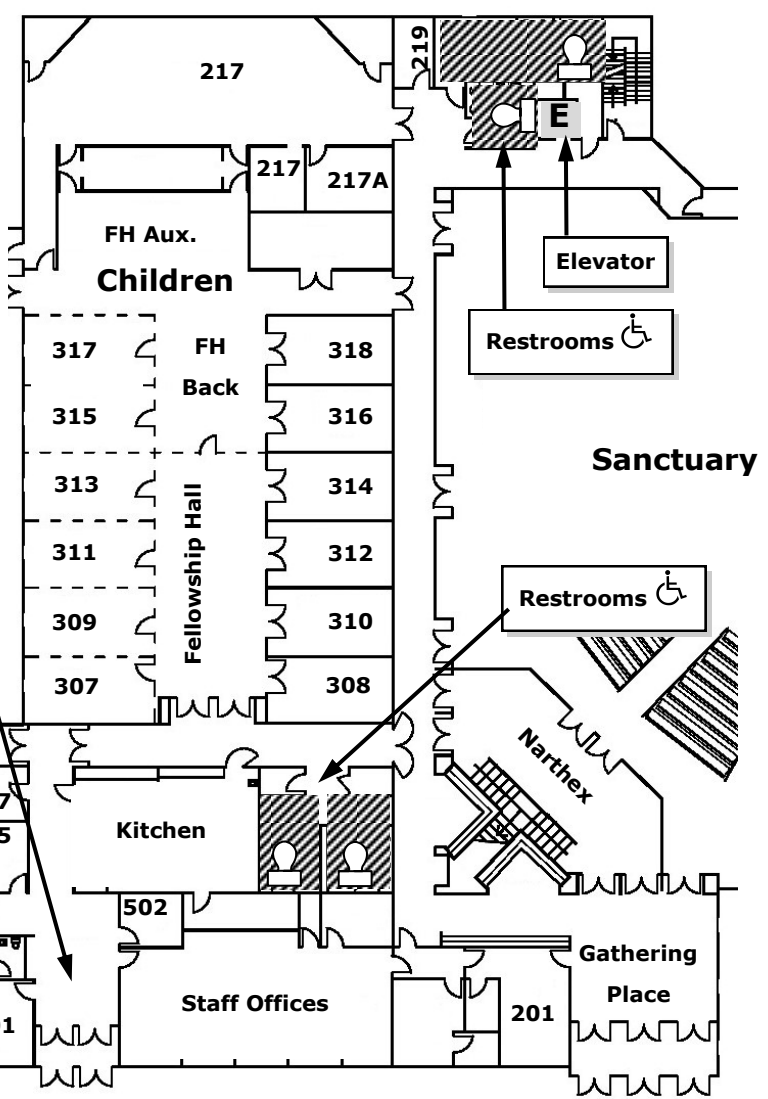

Sanctuary

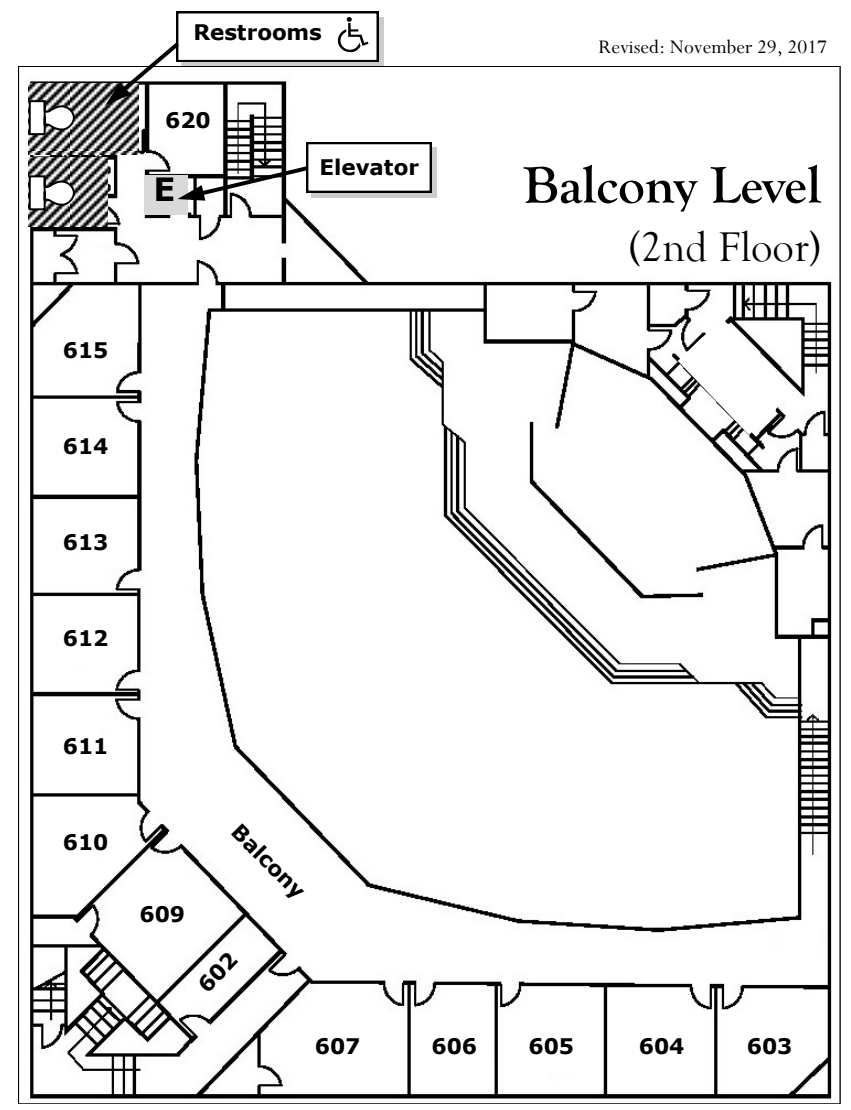

Balcony Level
(2nd Floor)

Revised: November 29, 2017

8:15 a.m. Sunday School

Adults: Director: Ron Hunt

- 108.... **Barnabas Bunch** C, fall Blythe
- 109.... **Lamplighters** M, winter.....C. Powell
- 111.... **Fellowship** C, fallEngle
- 114.... **Truth Seekers** C, FallBartley
- 201.... **Agape** W, winter..... Ramsey
- 217.... **Bykota**.....C, winter.....Collins
- 307.... **Bethany/Gleaners**... W, winter..... Ackerman
- 309....**Dorcas**.....W, winter.....S. Powell
- 311.... **Friendship**..... M, winter Moore
- 313....**Men** M, fallLykins
- 315/317....**Builders Bible**....W, fall.....Parks

9:30 a.m. Sunday School

Adults: Director: Ron Hunt

- EKU BCM..T2:12 (College).....C, Spring.....Walters
- 201 ... **Grace and Love**.....C, summer.....Gibbons
- 217 ... **Watchmen**.....C, summer.....Lynch
- 307.....**Magi**.....C, summer..... Hunt
- 309.....**THRIVE**.....C, spring.....Shepherd
- 311.....**Philippi**.....C, summer.....Curry
- 313 ... **PYC**.....C, spring.....York
- 607.....**Nearly/Newly Wed**...C, spring.....Bartley
- 609.....**Kingdom Builders**....C, summer..... Ward
- 620.....**Esther**..... W, fall.....Osborne
- 504A....**Deaf Ministry**.....C, summer.....Michel

9:30 a.m. Sunday School

Preschool Sunday School

- 401A/B.....Nursery (Bumble Bees)
- 402A..1's Toddlers (Caterpillars)
- 402B...2's (Buttercups)
- 402F...3's (Turtles)
- 405/407.....4's (Ladybugs)
- 411/413..5's/Kindergarten (Sunflowers)

Children Sunday School

- 312.....1st Gr Boys 314.....1st Gr Girls
- 310.....2nd Gr Boys 308.....2nd Gr Girls
- 318.....3rd Gr Boys 316.....3rd Gr Girls
- 315/317.....4th & 5th Gr Boys
- FH Back.....4th & 5th Gr Girls

Youth Sunday School

- 108...6th Gr Boys 107...6th Gr Girls
- 112...7th& 8th Gr Boys 109..7th & 8th Gr Girls
- 105...9th & 10th Gr Boys
- 114...9th & 10th Gr Girls
- 111...11th & 12th Gr CoEd

Cry Room (under balcony)

11:00 a.m. Sunday School

Adults: Director: Ron Hunt

- 111....**Adult Spanish**C, Valle
- 217....**Family Ties**C, fall..... S. Powell
- 307.... **Single-Minded**.....C, summer.... C. Powell
- 309....**Sojourners**.....C, fall.....Collins
- 311....**J. O. Y.**C, winter.....Wright
- 313....**Sisters**.....W, summer.....P. Fort

315/317..... **Youth Spanish**

FH Aux/316/318..... **Preschool/Children Spanish**

6:00 p.m. Sunday School (Thursday)

Adults: Director: Ron Hunt

Youth Area ... **Celebrate Recovery**....C,.....E. Gay

Key:

| | |
|------------|------------------------|
| C: Coed | Spring: Ages 18-29 |
| M: Men | Summer: Ages 30-49 |
| W: Women | Fall: Ages 50-69 |
| S: Singles | Winter: Ages 70 and up |