

# Welcome

---

Dear Friends,

Welcome to First Baptist Church! We are glad that you have chosen to worship with us. I hope this guide will help you find your destination here at our church. If you still encounter difficulties finding your location, please ask anyone and we would be happy to help.

These room numbers and locations are important but they represent so much more. They represent rooms where Scripture is studied and friendships are made. We hope that God will revolutionize your life through the Bible and wonderful Christian friendships. I trust you will find a place to develop and grow in faith in Jesus.

The Bible tells that God loves us and offers a wonderful plan for our lives. God's plan is always fulfilled in a local body of believers. The church is a place where strength can be drawn and faith can be developed. Please find an evangelical church where you can receive that strength and grow your faith. This guide may help you find your place within the building that houses First Baptist Church, but for all of us, the ultimate destination is in a relationship with God's Son, Jesus. May God bless you as you journey through this building and as you journey through life.

In His Love,



Senior Pastor

## Wednesday Evening Activities

---

### (Late August - mid-May)

|  |  |
|--|--|
| <b>Adult Bible Studies</b> .....6:00-7:30 PM | <b>Nursery/Childcare</b> .....6:00-7:30 PM |
| Bible Study with the Pastor ..... Sanctuary  | Infants ..... 401A                         |
| All remaining studies.....Balcony            | Toddlers & 2 yr olds .....402B             |

|  |   |
|--|---|
| <b>Youth</b> .....6:00-7:30 PM                                       | <b>Kingdom Sprouts (Preschool)</b> 5:30-7:30 PM |
| Cross LIFE (6 <sup>th</sup> -12 <sup>th</sup> Grade)..... Youth Area | 3 Yr Olds ..... 402F                            |
|  | 4 Yr Olds ..... 407                             |
|  | 5 Yr Olds ..... 413                             |

|  |
|--|
| <b>Kreative Kids (Children)</b> 5:30-7:30 PM |
| 1st - 5th Grade .....F.H. Back               |

alive!  
in the power of God

- aadore God
- love all people
- iinvest in God's work
- Value God's word
- eexpand God's kingdom

FIRST BAPTIST CHURCH  
425 Eastern ByPass  
Richmond, KY 40475  
(859) 623-4028  
[www.fbcrichmondky.church](http://www.fbcrichmondky.church)

For more information contact:  
Sam Newman, Minister of Education/Discipleship  
[sam.newman@firstbaptistnet.com](mailto:sam.newman@firstbaptistnet.com)

# First Baptist Church

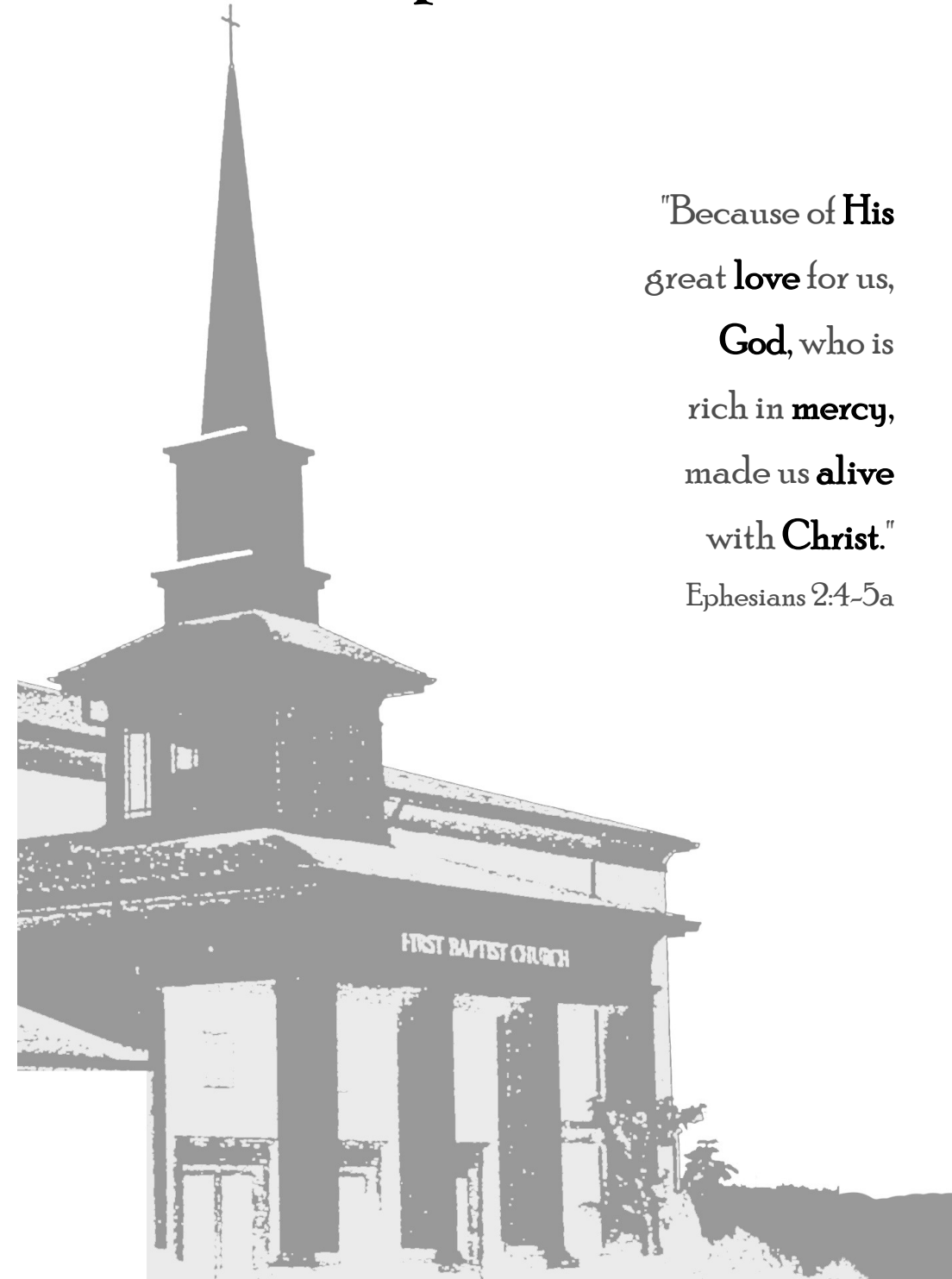

"Because of His  
great **love** for us,  
God, who is  
rich in **mercy**,  
made us **alive**  
with **Christ**."  
Ephesians 2:4-5a

## Ministry Activity Guide

### Sundays & Wednesdays

Sunday School • Worship • Discipleship

## Sunday Morning

Worship .....9:30 & 11:00 AM  
 Nursery/Childcare (Birth-2 Yrs) ..... 8:00 AM  
 Bible Study (Adults) ..... 8:15, 9:30, 11:00 AM  
 Bible Study (Youth).....9:30 AM  
 Bible Study (Children) .....9:30 AM  
 Bible Study (Preschool).....9:30 & 11:00 AM  
 Hispanic Worship ..... 12:15 PM  
 (Contact Sam Newman, 859-623-4028, ext. 203

regarding Hispanic Bible Studies.)

## Sunday Evening

All Activities .....6:00 PM  
 Worship ..... Fellowship Hall Front  
 Nursery/Childcare..... Preschool Wing

**Childcare**

We encourage you to enroll your child into one of our outstanding children's programs during our A.M. and P.M. events and let them experience God their way. There is also a Cry Room located at the

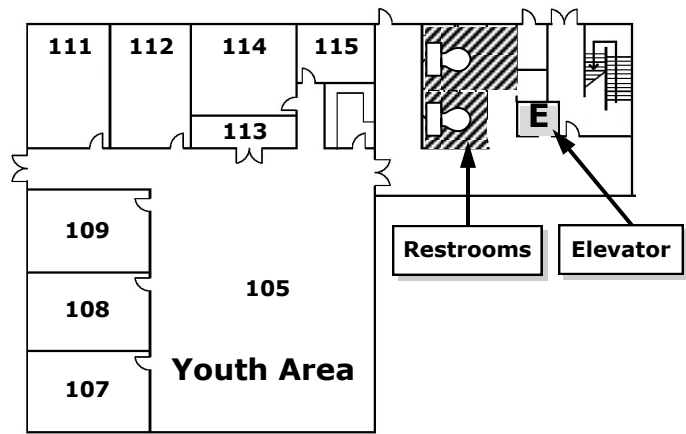

**Lower Level**  
(Ground Floor)



**Main Level**

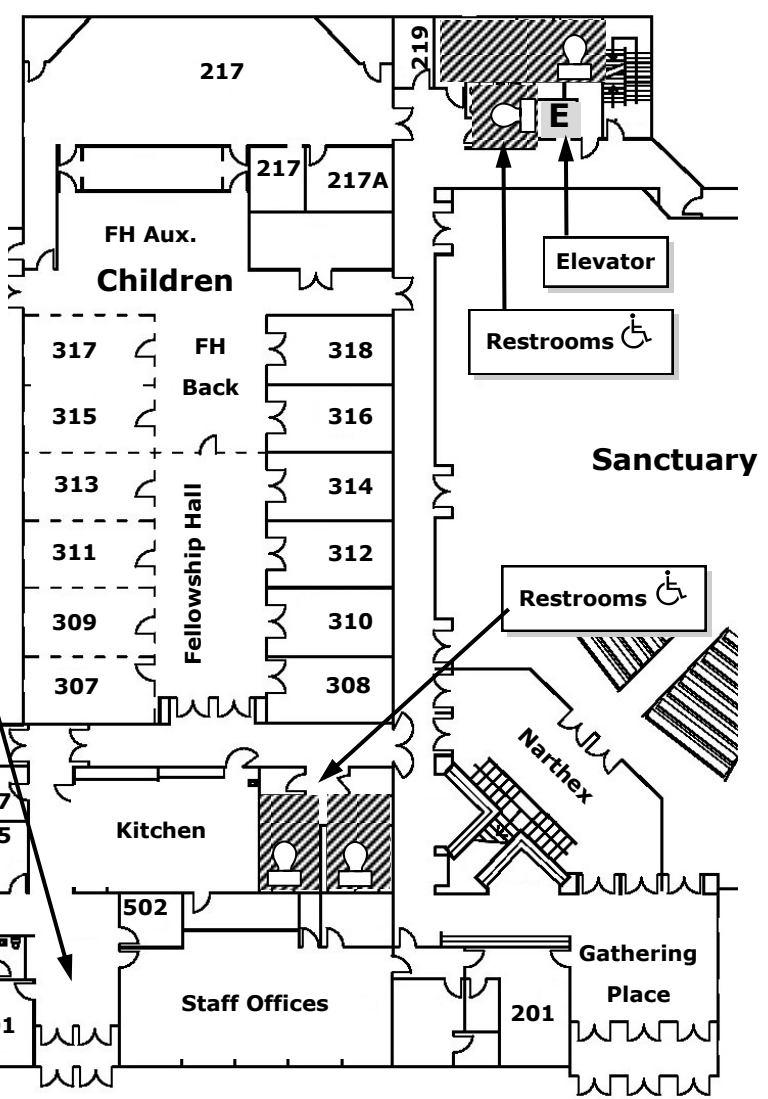

**Sanctuary**

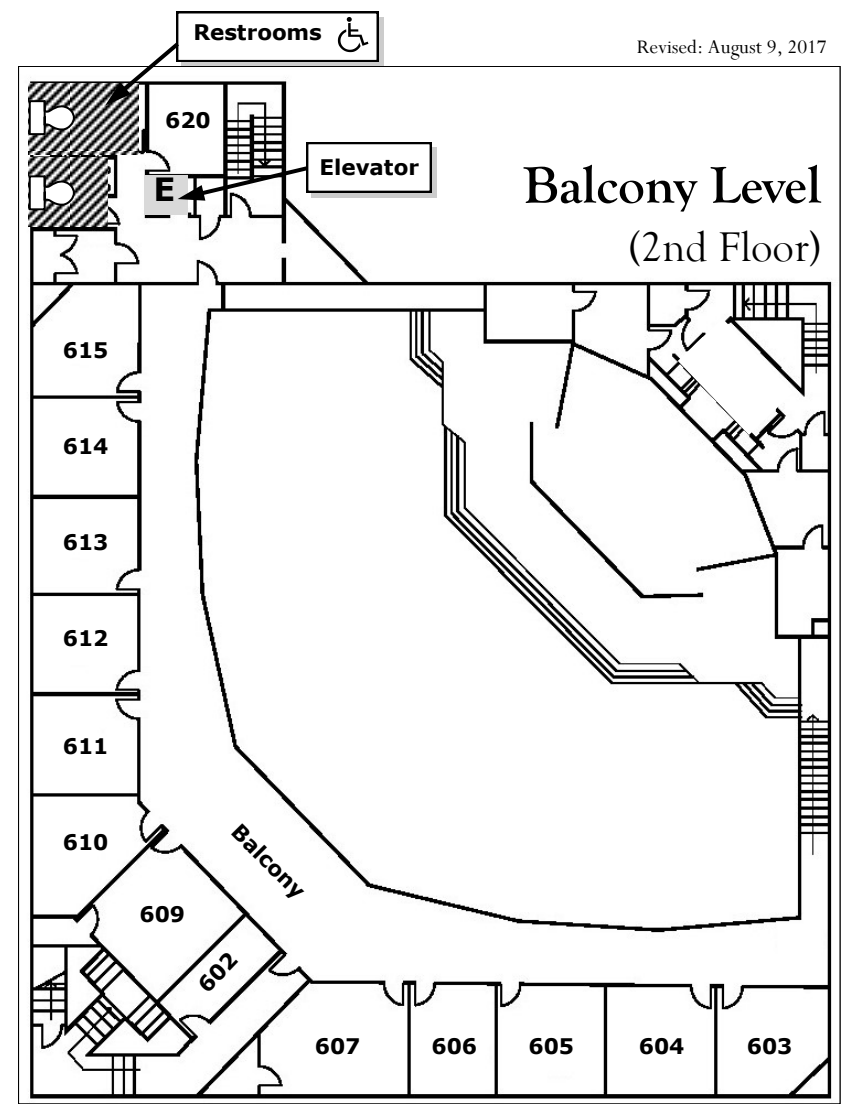

**Balcony Level**  
(2nd Floor)

**Cry Room (under balcony)**

Revised: August 9, 2017

### 8:15 a.m. Sunday School

**Adults: Director: Ron Hunt**

108.... **Barnabas Bunch** ..... C, fall ..... Blythe  
 109.... **Lamplighters** ..... M, winter.....C. Powell  
 111.... **Fellowship** ..... C, fall .....Engle  
 114.... **Truth Seekers** ..... C, Fall .....Bartley  
 201.... **Agape** ..... W, winter..... Ramsey  
 217.... **Bykota**.....C, winter.....Collins  
 307.... **Bethany/Gleaners**... W, winter..... Ackerman  
 309....**Dorcas**.....W, winter.....S. Powell  
 311.... **Friendship**..... M, winter ..... Moore  
 313....**Men** ..... M, fall ..... Lykins  
 315/317....**Builders Bible**... W, fall..... Parks

Nursery Available in Preschool Wing

### 9:30 a.m. Sunday School

**Adults: Director: Ron Hunt**

EKU BCM.. **T2:12 (College)**.....C, Spring.....Walters  
 201 ... **Grace and Love**.....C, summer.....Hunt  
 217 ... **Watchmen**.....C, summer.....Lynch  
 307.....**Magi**.....C, summer..... Brooks  
 313 ... **PYC**.....C, spring.....York  
 609.....**Kingdom Builders**.....C, summer..... Ward  
 615.....**THRIVE**.....C, spring..... Shepherd  
 620.....**Esther**..... W, fall.....Osborne  
 504A.....**Deaf Ministry**.....C, summer.....Michel

### 9:30 a.m. Sunday School

**Preschool Sunday School**

401A/B.....Nursery (**Bumble Bees**)  
 402A.. .....1's **Toddlers (Caterpillars)**  
 402B... .....2's (**Buttercups**)  
 402F... .....3's (**Turtles**)  
 405/407.....4's **Ladybugs**  
 411/413..5's/**Kindergarten (Sunflowers)**

**Children Sunday School**

312.....1st Gr Boys      314.....1st Gr Girls  
 310.....2nd Gr Boys      308.....2nd Gr Girls  
 318.....3rd Gr Boys      316.....3rd Gr Girls  
 315/317.....4th & 5th Gr Boys  
 FH Back.....4th & 5th Gr Girls

**Youth Sunday School**

107...6th Gr Boys      108...6th Gr Girls  
 114...7th& 8th Gr Boys      111...7th & 8th Gr Girls  
 105...9th & 10th Gr Boys  
 112...9th & 10th Gr Girls  
 109...11th & 12th Gr CoEd

### 11:00 a.m. Sunday School

**Adults: Director: Ron Hunt**

111....**Adult Spanish** .....C, .....Valle  
 217....**Family Ties** .....C, fall..... S. Powell  
 307.... **Single-Minded**.....C, summer.... C. Powell  
 309....**Sojourners**.....C, fall.....Collins  
 313....**Sisters**.....W, summer.....P. Fort

315/317..... **Youth Spanish**  
 FH Aux/316/318.....**Preschool/Children Spanish**

### 6:00 p.m. Sunday School (Thursday)

**Adults: Director: Ron Hunt**

Youth Area ... **Celebrate Recovery**....C,.....E. Gay

|             |            |                        |
|-------------|------------|------------------------|
| <b>Key:</b> | C: Coed    | Spring: Ages 18-29     |
|             | M: Men     | Summer: Ages 30-49     |
|             | W: Women   | Fall: Ages 50-69       |
|             | S: Singles | Winter: Ages 70 and up |